

ROCKWELL TYPE HARDNESS TESTER CV-631™

Bench hardness tester with protruding nose for internal tests

- Automatic load selector
- Horizontally protruding nose type machine
- Tests on difficult to reach areas
- Tests on internal surfaces from 40mm diameter with standard indenter and 23mm with short indenter
- Tests on external surfaces down to approx 3mm diameter (hardness dependant)
- Automatic test cycle
- Clear matrix backlit LCD
- Data output to printer TA-220
- Easy menu selectable screens for display and control
- Four models of diamond indentors available:

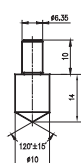

Standard

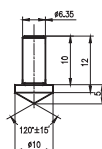

Short

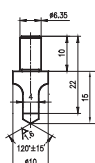

Chisel

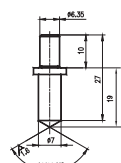

Slim

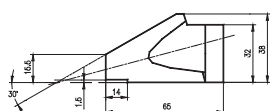

Dimensions of protruding nose



Technical specifications

Hardness parameters	A, B, C, D, E, F, G, H, K, L, M, P, R, S, V
Hardness resolution	0.1 of a Rockwell unit
Test loads	10kgf preload / 60, 100, 150kgf total load
Display	Matrix backlit LCD
Language	English
Data entry	Membrane keypad, menu driven
Test cycle	Automatic
Load duration	Programmable dwell and recovery times 2-50sec
Data output	USB, RS232 serial port for printer TA-220/computer
Menu features	Upper/lower hardness limits settings and alarm Data statistics: Ave., Max., Min., S.R. Scale conversion: converts tested value to Vickers, Leebs, Brinell, Rockwell superficial, UTS Curve correction: cylinder and sphere Test force switches automatically Automatic data storage within 500 data groups, Hardness & Strength conversion also for aluminum, alloy aluminum copper and alloy copper
Standard	EN-ISO 6508, ASTM E-18
Specimen accommodation	Vertical space 260mm (10.24") Horizontal space (from centre-line) 150mm (6")
Specimen access	External surfaces Cylindrical surfaces down to 3mm diameter Internal surfaces Cylindrical surfaces down to 23mm diameter
Power supply	220V or 110V, 50Hz
Machine dimensions	Width 225mm, depth 715mm, height 790mm
Machine weight	100kg

Standard delivery

- Main unit
- 120° Cone diamond indenter
- Ball indenter 1/16"
- Spare balls 1/16" (5 pcs)
- Fixing screw for indentors
- Flat anvil 70mm diameter
- V-anvil 30mm diameter
- Test block HRA
- Test block HRB
- Test block HRC (3 pcs)
- Power cable
- Certificate
- Manual

Optional accessories

- Short diamond indenter
- Chisel diamond indenter
- Slim diamond indenter
- Ball indenter 1/8"
- Ball indenter 1/4"
- Ball indenter 1/2"
- Flat anvil 225mm diameter
- Flat anvil 150mm diameter
- V-anvil large
- V-anvil flat
- Support fixtures
- Printer TA-220 with cable
- UKAS certified test blocks